

## NC Nesting

### Application Overview / Market Segment Introduction:

NC Nesting is an embedded tool inside Creo (Pro/ENGINEER) for border offset & sheet metal component placement based on raw material size.

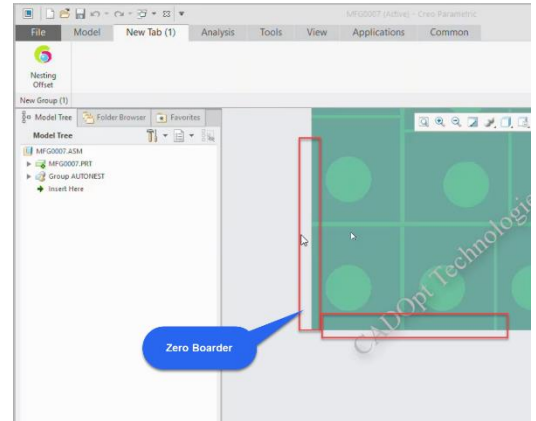
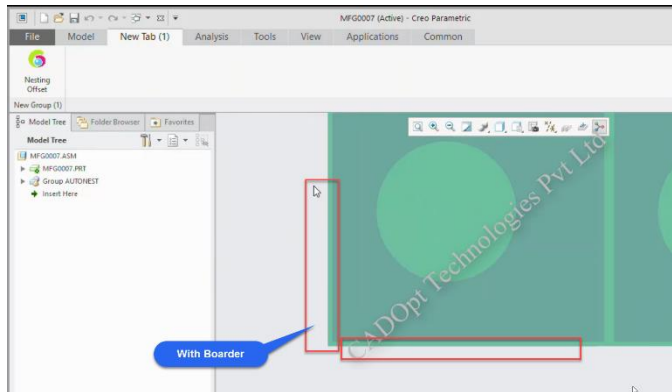

### **Current Scenario (Without Application):**

- ➔ Manually not possible to apply the border offset & sheet metal component placement in NC automation.

### **Negative consequences:**

- Raw material wastage.

### **Positive Business Outcome:**

- **ROI** – quick Return on Investment (ROI) considering the significant reducing raw material usage.
  - **Speed** – One click solution to apply the border offset & sheet metal component placement.
  - **Enhanced User Productivity** - Eliminate Designer's /Creo User's non-productive (manual entries) activities by saving up to 90% design time & save raw material.
- **Quality output:**
  - **Error Free** – Eliminates arrangement errors.

### **How it adds value:**

- Works with PTC Creo (Pro/ ENGINEER) NC Sheetmetal Licenses only.
- One-click solution that automatically determines and apply the border offset.
- Sheet metal component placement with less raw material wastage.
- Recognizes size & shape of the models.

### **List of satisfied users:**

- PTC

For more info contact CADOpt Technologies Private Limited at: [info@CADOpt.com](mailto:info@CADOpt.com) or visit our website at [www.CADOpt.com](http://www.CADOpt.com)